

Baruch Houses Recovery to Resilience Flood Walls

P6

- ✓ Flood wall on Baruch Drive and other flood proofing measures to protect buildings in flood-prone areas.

P7

p11

Note double layer wall

SEATING AREA AT FLOODWALL



p13

Will residents be required to walk around the proposed flood wall to reach the other side of Baruch Drive?

No. The proposed flood wall on Baruch Drive will feature four access points that will comply with the Americans with Disabilities Act (ADA). Residents can use these access points to reach either side of Baruch Drive.



Wald Houses

P8 elevated entry flood protection

Proposed Entrance Design Incorporating Ramps and Flood Protection

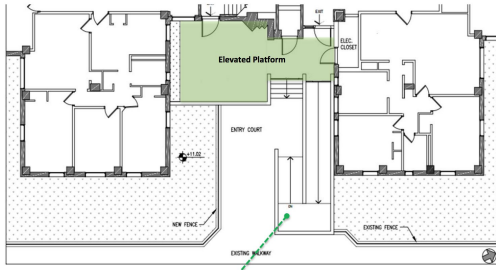

Riis Houses

P13 -
deployable walls

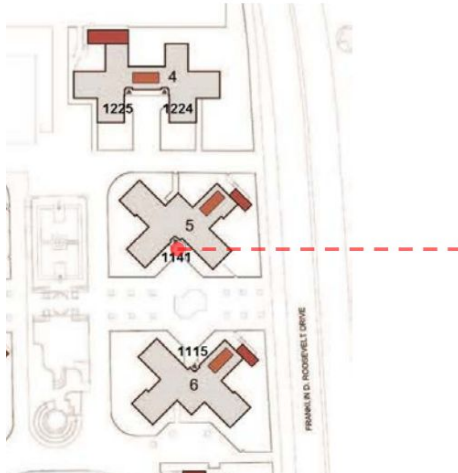

Typical Flood Barriers



NYCHA Map

Interactive Sandy Transparency Map

All Projects

Project Completed

Project In Design

Project In Procurement

